



## Dean Close

Melksham SN12 7EZ

- Detached
- Generous Corner Plot
- Quiet Area
- Three Bedrooms
- New Kitchen & Bathrooms
- Driveway

**Asking Price £315,000 Freehold**





### **Hall**

Window and door to side elevation, doors to living room, bedroom three, bathroom and under stairs cupboard, stairs to first floor and radiator.

### **Living Room**

Window to front elevation, fireplace, opening to dining room and radiator.

### **Dining Room**

Window and door to side elevation, door to kitchen and cupboard.

### **Kitchen**

Fitted with a matching range of base and eye level units with worktop space over space for fridge/freezer and washing machine, built in electric fan assisted oven, four ring gas hob and extractor hood over, window and door to rear elevation and door to cloakroom.

### **Cloakroom**

Fitted with a two piece suite comprising of wash hand basin and close coupled WC, window to rear elevation and heated towel rail.

### **Landing**

Doors to bedrooms.

### **Bedroom One**

Window to front elevation, two cupboards and radiator.



**Bedroom Two**

Two windows to rear elevation, cupboard and radiator.

**Bedroom Three**

Window to front elevation and radiator.

**Bathroom**

Fitted with a three piece suite comprising of bath with shower over and glass screen, wash hand basin and close coupled WC, window to side elevation and heated towel rail.

**Garden**

Fully enclosed with side access, mainly laid to lawn with concrete paths and space for a shed.

**Driveway**

Located to the side of the property with space for up to three vehicles.



Local Authority **Wiltshire**  
Council Tax Band **D**  
EPC Rating **C**

### Ground Floor

Approx. 60.7 sq. metres (653.4 sq. feet)

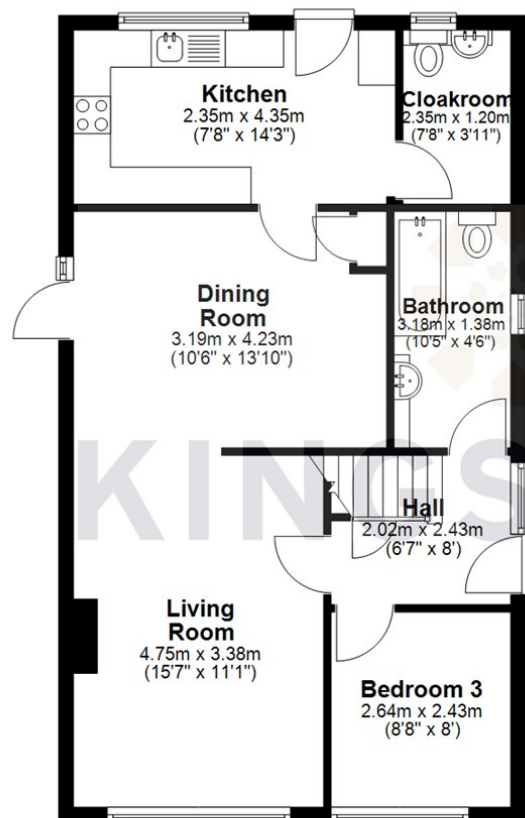

### First Floor

Approx. 35.0 sq. metres (376.3 sq. feet)

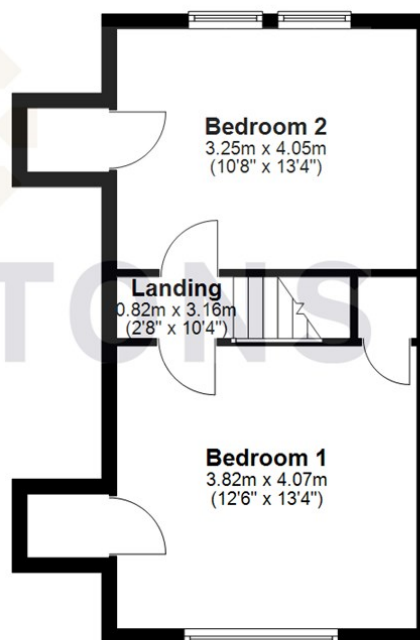

Total area: approx. 95.7 sq. metres (1029.6 sq. feet)



**KINGSTONS**

**Melksham Office**

11 High Street, Melksham,  
Wiltshire, SN12 6JR

### Contact

01225709115  
sales@kingstons.biz  
www.kingstons.biz

Agents Note: Whilst every care has been taken to prepare these particulars, they are for guidance purposes only. All measurements are approximate and for general guidance purposes only and whilst every care has been taken to ensure accuracy, they should not be relied upon and potential buyers/tenants are advised to recheck the measurements.

